



BEFORE



AFTER

PROJECT DETAILS

**Homeowners** Liz Pellington, a volunteer for Citizens Advice, and husband Andy, a chief financial officer **Location** St Albans, Hertfordshire **Property** Detached, five-bedroom, Twenties house

BUDGET BREAKDOWN

**Fees** £15,000 **Build cost** £90,000 **Bi-fold doors** £12,000 **Roof lights** £10,000 **Kitchen & worktops** £40,000 **Appliances** £12,500 **Flooring** £2,800

TOTAL SPEND

**£182,300**

THE BRIEF

To extend the kitchen to create a spacious family room at the rear of the detached house, with two sets of bi-fold doors improving access to the outdoor terrace and garden. Use curved aluminium roof eaves to conceal a gutter

THE FLOORPLAN

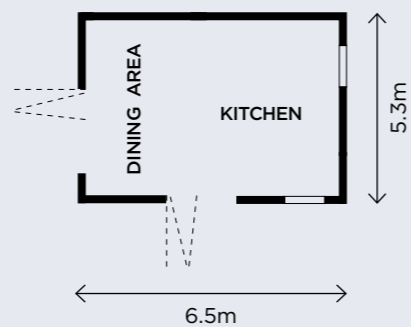

PROJECT NOTES

Opting for a combination of timber-framed bi-fold doors, a wooden dining table and oak kitchen units adds instant warmth and texture to this open-plan space

STEP OUTSIDE

One set of bi-folds opens on to the paved terrace at the side of the extension, which now has the feel of a sunny, enclosed courtyard

KITCHENS SPECIAL

**'We're connected to the garden now'**

Extending their Hertfordshire home has transformed Liz and Andy Pellington's cramped kitchen into a bright, open-plan room that links to the outside space

FEATURE BETH MURTON PHOTOGRAPHER ANDREW HATFIELD

Good transport links to central London and the overall size of the house and back garden were the main selling points when Liz and Andy Pellington bought their detached home in St Albans, Hertfordshire, back in 2006. But as it only had a small, east-facing kitchen, however, the rear of the house was definitely ripe for improvement. 'It was always very cramped and dark in the kitchen and you had to put the light on all the time – even in the middle of the day during the summer,' Liz recalls. There was also another issue: 'There wasn't really any link with the

garden, either, as you had to walk through the utility room to get outside,' she adds. Unsure of the best way to improve the property, the couple lived with the existing layout for a few years while they considered their options and saved up funds. In 2014, Liz and Andy felt that the time was right to tackle the redesign, so they commissioned Ian Harvey of Harvey Norman Architects, who had completed several projects in the area, to take on the extension. 'We visited one of the houses Ian had redesigned and spoke to the homeowners about how they'd found the experience,' Andy explains. The couple came away suitably impressed:

'It certainly reassured us that he was the right person for the job,' he adds. The couple's brief was to remove the old utility room at the back of the house and replace it with a large extension, in order to create a bright and spacious layout with separate zones for the kitchen, dining and living areas, as well as access to the garden from both sides of the space. Features such as a practical utility room and separate WC were also essential requirements, which meant redesigning part of the existing ground-floor layout to accommodate everything on their wishlist. Designed to fall within the guidelines for permitted development so it didn't ▶



➤ **DISPLAY AREA**  
Built-in shelves with ambient lighting provide space for tasteful curation of favourite objects

➔ **COLOUR MATCH**  
Red brick mirrors the front of the property, with garden furniture in a similar hue helping to unify the scheme



**OLD & NEW**  
The light-filled kitchen is a stylish combination of modern and classic styles

SHOPPING BASKET

- GLAZING** Timber bi-fold doors, side door and windows, £12,000, Kløeber. Roof lights, £10,000, Glazing Vision
- KITCHEN & WORKTOPS** Shaker-style kitchen with antique brown granite worktops, £40,000, Harvey Jones
- APPLIANCES** For a similar American fridge-freezer, try LG GSL561PZUZ, £1,199; for a similar built-in electric single oven, try Miele H2265BP, £619; for a similar built-in wine cooler, try Miele KWT6321UG, £1,770, all Ao.com
- FLOORING** Casalgrande Padana Marte floor tiles, £42 per sqm, Verulam Tile Warehouse
- LIGHTING** Pendant lights, £300 each, Masters in Light
- FIREPLACE** Dru Global gas fire with Chinese black granite surround, £1,890, Chiswell Fireplaces
- FURNITURE** Magis Bombo bar stools, £492 each, John Lewis. For a similar dining table, try oak Studio, £1,650, Blacks of Sopwell. Ely dining chairs, from £119 each; Rimini sofa, from £1,599, all Multiyork. Henley curved glazed dresser, £2,900, Neptune

WHERE TO BUY  
TURN TO  
p165

require planning permission, the new single-storey extension stretches across half of the width of the house with the overhanging flat roof featuring aluminium detailing to create a contemporary look. Multicoloured red bricks that mirror the appearance of the front of the Twenties property provide a visual contrast to the rendered rear façade of the house.

To bring much-needed natural sunshine into the space, there are four large roof lights over the kitchen and dining area, while two sets of matching bi-folds open into the garden. ‘We opted for timber-framed doors because we liked the balance between the modern design and the use of traditional materials,’ Andy explains.

As well as overseeing the tender process to find the right builder for the six-month project, Ian also offered invaluable advice on choosing the majority of the fixtures

and fittings. A timeless Shaker-style kitchen in a stylish combination of oak and cream-painted units adds character, while underfloor heating and large-format porcelain tiles in a neutral shade make for a smart and practical combination in this contemporary indoor-outdoor space.

‘We worked with Harvey Jones’ designer from the beginning,’ Andy says. ‘It was a really good decision: the kitchen fitted perfectly within the planned footprint of the extension, so we didn’t have to compromise on our preferred layout.’

Andy and Liz couldn’t be more thrilled with the finished results. ‘Our kitchen is always so bright and there’s plenty of space for family and friends to spend time together,’ says Liz. ‘But the biggest transformation is the improved connection with the garden. It’s even better than we ever imagined.’ GH